

SSB 200-2500

Stainless Steel Storage Cylinders for DHW Applications



The Adveco range of stainless steel domestic hot water tanks includes models suitable for use as hot water buffers, single coil, or dual coil calorifiers as required for the job.

The SSB range serve as buffer vessels only, supplied with two blank flanges and no internal heat exchange coils. With top and bottom tank connections and the capacity to install an electric immersion heating element, the SSB can be used to expand the dump load capacity of a hot water installation in addition to providing a level of redundancy to a domestic hot water system.

The complete range of tanks are WRAS certified, and are designed and manufactured to the requirements of the Pressure Equipment Directive (97/23/EC) and are tested to the procedure defined in BS EN 12897:2006.

FEATURES

- Available with 200 - 2500 litre capacities
- Produced from high quality stainless steel
- 100-130 mm removable insulation for improved energy efficiency
- Suitable for vented or unvented installation
- Immersion heaters available from 3 - 36 kW
- 6 bar / 85°C max. working pressure/temperature
- Hot water storage or electric water heater



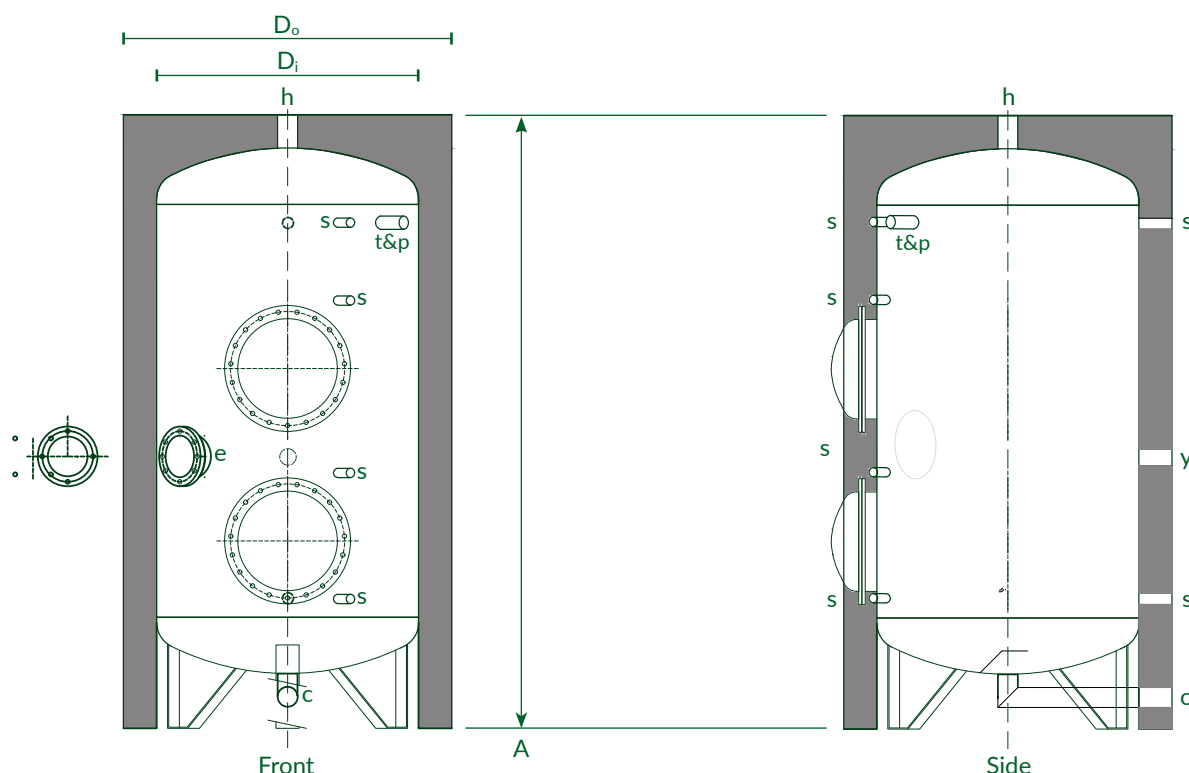

Model	units	SSB 200	SSB 300	SSB 500	SSB 800	SSB 1000	SSB 1500	SSB 2000	SSB 2500
Volume	L	191	286	481	763	952	1426	2002	2535
D _o	mm	650	700	850	1050	1050	1260	1510	1660
D _i *	mm	450	500	650	790	790	1000	1250	1400
A	mm	1445	1735	1785	1865	2195	2250	2090	2180
c Cold Inlet	inch	1.25	1.50	1.50	2.00	2.00	2.00	2.00	2.50
h Hot Outlet	inch	1.25	1.50	1.50	2.00	2.00	2.00	2.00	2.50
y Secondary	inch	1.50	1.50	1.50	1.50	1.50	1.50	1.50	1.50
s Sensor	inch	0.75	0.75	0.75	0.75	0.75	0.75	0.75	0.75
t&p Temperature & Pressure Relief	inch	1.00	1.00	1.00	1.00	1.50	1.50	1.50	1.50
e Immersion Port	inch, mm	2.25"	2.25"	180	180	180	180	180	180
Standing losses	W	75	96	100	120	143	158	190	208
	kWh/24h	1.8	2.3	2.4	2.9	3.4	3.8	4.5	4.9
Energy efficiency class		C	C	C	C	C	C	C	C
Empty mass	kg	79	87	124	159	195	255	330	430

Ancillaries: All models

Control Thermostat: E0008/0-95C	Overheat Thermostat: E0011
Thermostat Pocket: E0009.2 (2x included with vessel)	Destratification Pump Kit: MB0001
Unvented Kits: Contact Adveco for details	Electric Immersion Heaters: Contact Adveco for details